

PR03 Series



Quick Start Guide

Document Version: v1.5

AVIWEST
*Shaping tomorrow's **live** video*

Parc Edonia, Bat. X1
Rue de la Terre de Feu
35769 Saint Grégoire Cedex
France
Tel: +33 2 56 56 50 14
Email: info@aviwest.com

Front View

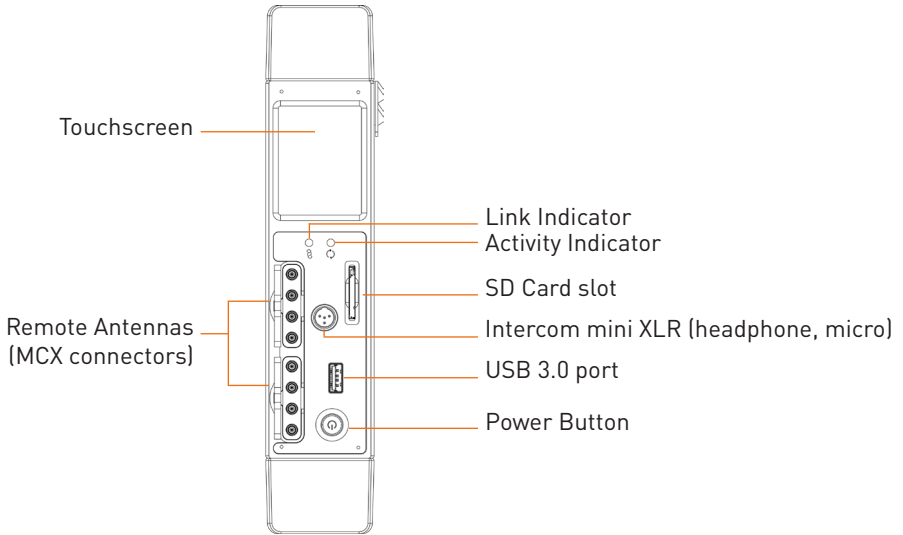

Rear View

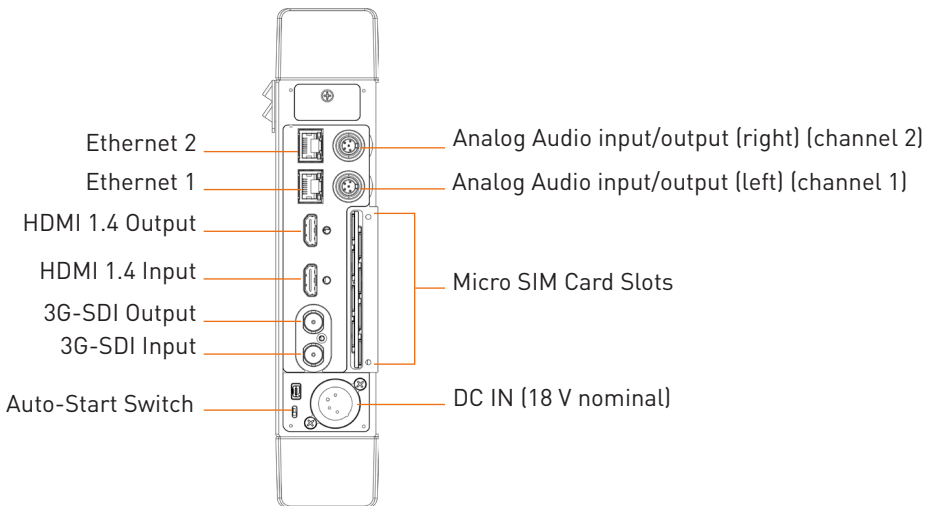

Left and right sides

Camera Mounting plate
(Gold Mount, V-mount)

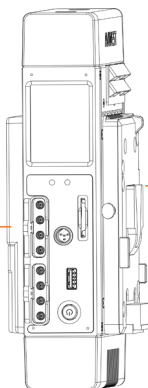

Battery Mounting plate
(Gold Mount, V-mount)

Getting ready

1. Install an external battery onto the unit or connect the AC/DC adapter to the unit.

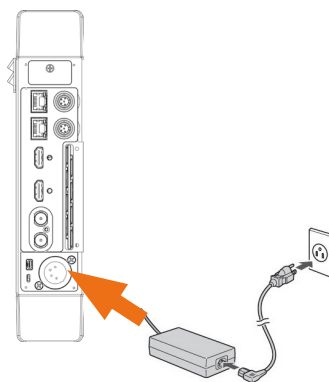
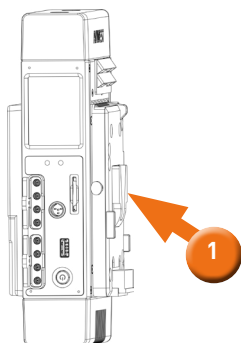

2. Insert a SD card

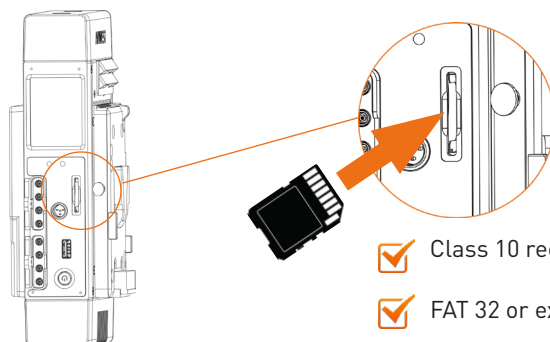

- ✓ Class 10 recommended
- ✓ FAT 32 or exFAT

3. Insert SIM cards into slots.

 Micro SIM cards required.

a) Remove the SIM card cover.

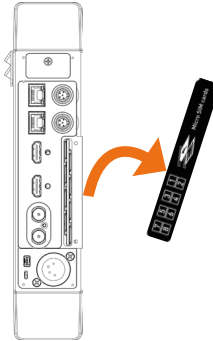

b) Insert SIM cards according to indications on cover.

For PRO340



For PRO360-5G



For PRO380

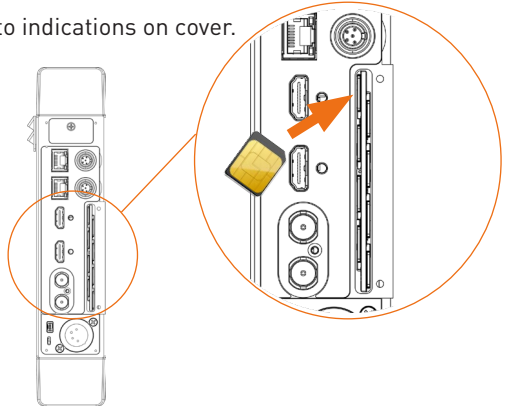

When using the unit in the USA, we recommend inserting SIM cards as follows:

SIM slot Number	US Operator
1	AT&T
2	T-Mobile
3	Verizon
4	AT&T
5	T-Mobile
6	Verizon
7	AT&T
8	T-Mobile

c) Place the rear cover back.

4. Connect the video input cable (either HDMI or SDI).

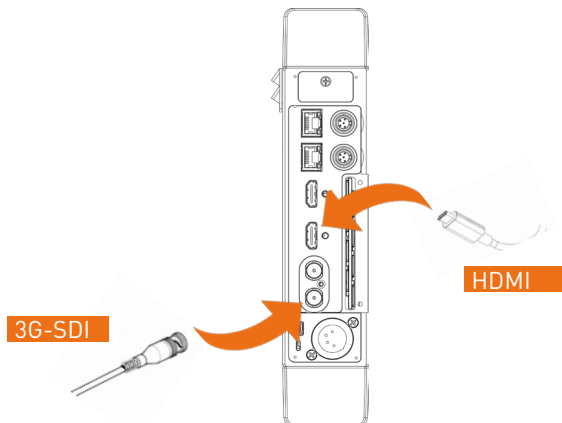

Turning on the unit

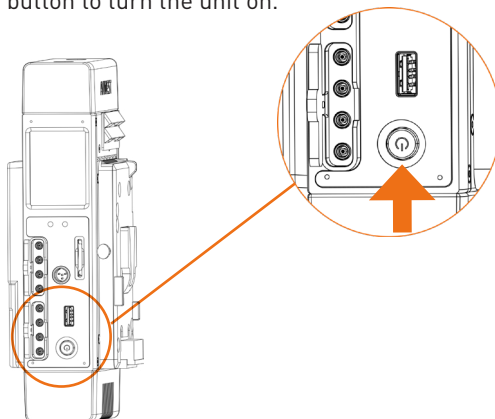

Press the power button to turn the unit on.

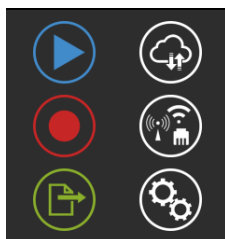

When the unit is ready, the Home screen appears:



Selecting a Video Source



1. From the Home menu, click on .
2. Click on .
⇒ The default source is Auto.
3. Check that video source is Auto.



4. If not (SDI, HDMI or Pattern), click on the Video source Field and select Auto.



Configuring a Destination Profile

1. Click on  and on  to access the DESTINATION CONFIG menu.
⇒ By default no profile exists.

2. Click on  to create a Destination Profile.



3. Click on the Profile Name field.



4. Use the keyboard to enter the new profile name.





5. Click on .

6. Click on  to configure the Profile settings:

- StreamHub IP address or Hostname
- Input assignment on the StreamHub set to Automatic
- Auto-connect function enabled

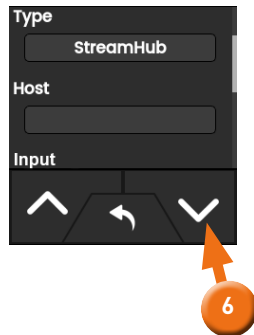
Make sure that Port number, Username or Password fit with settings entered from the StreamHub server.



7. Click on  to save the new Destination Profile.

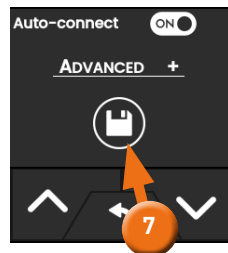

Starting a Live

1. From the Home menu, click on .



2. Click on  to go to the LIVE menu.

The LIVE menu displays information:

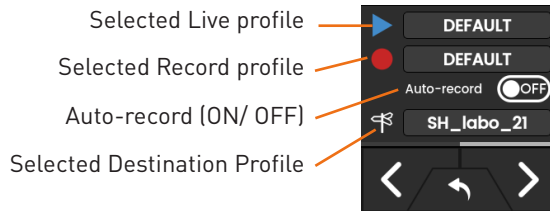

3. Click on  and on  to start a Live.

4. Click on  for more indications.

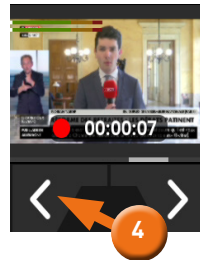

Some indications are displayed:

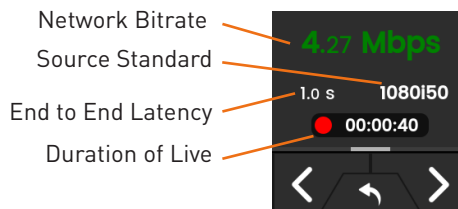



When Auto-record is enabled, additional indications appear:

Remaining Recording Time possible on SD card

Space used on SD Card

Duration of Live



Stopping a Live

1. Click on

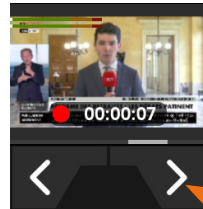

2. Click on

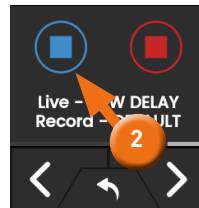



3. Click on

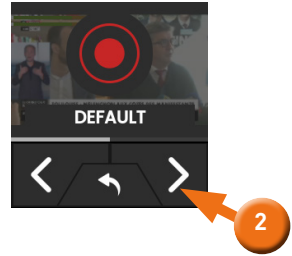

Starting a Record

1. From the Home menu, click on .



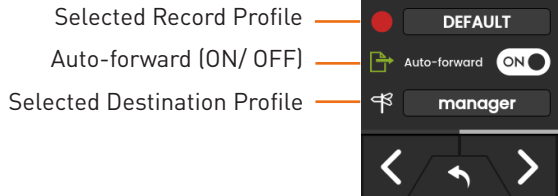

2. Click on  to go to the RECORD menu.

The RECORD menu displays information:

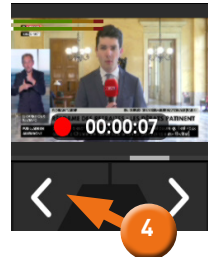

3. Click on  and on  to start a Record.



4. Click on  for more indications.

Some indications are displayed:

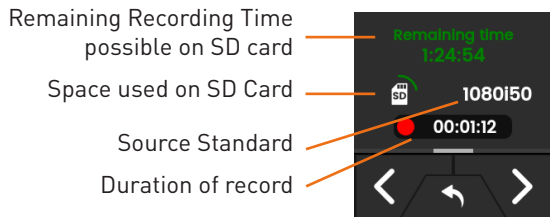



In case of a Record and Forward, additional indications appear:

Network Bitrate — 3.53 Mbps

Amount and percentage of data already forwarded — 27.0 MB – 80%

Duration of record — 00:00:31

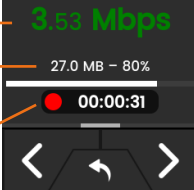

Stopping a Record

1. Click on .

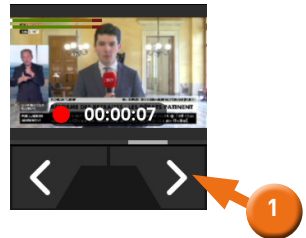

2. Click on .



3. Click on .

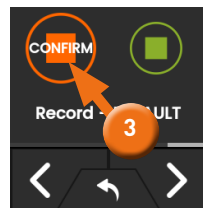

Starting a Forward

1. From the Home menu, click on .

The Forward menu appears:

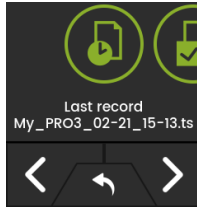

2. Select a type of Forward.

To forward the last record:

Click on .

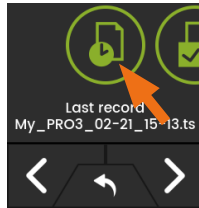

To forward all files:

a) Click on .

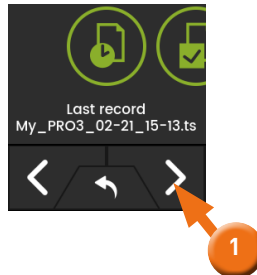

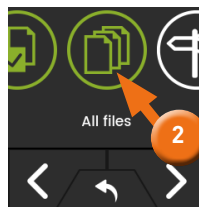

b) Click on .

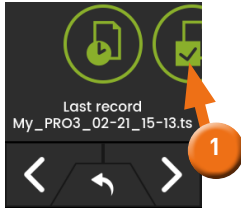

To forward some specific files:

a) Click on .



b) Click on .



c) Click on files to be forwarded.

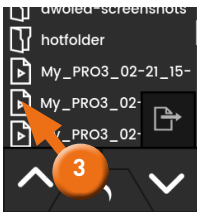

d) Click on .



During forward, some indications are displayed:

Number of files still to be forwarded

Network Bitrate

Amount and percentage of data already forwarded

Duration of forward

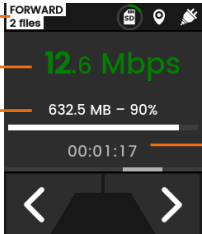

A screenshot of the "FORWARD" screen during file transfer. It shows "2 files" at the top. The network bitrate is displayed as "12.6 Mbps" in green. Below that, it shows "632.5 MB - 90%" with a progress bar. At the bottom, the duration is "00:01:17". Navigation arrows are at the very bottom.

Stopping a Forward

1. Click on .

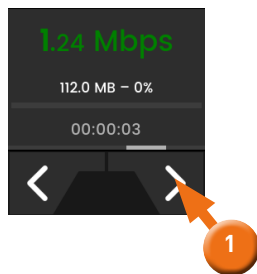

2. Click on .

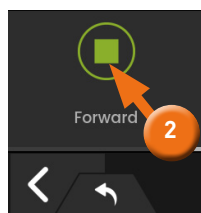

3. Click on .



Turning off the unit

Long press the power button to turn the unit off.

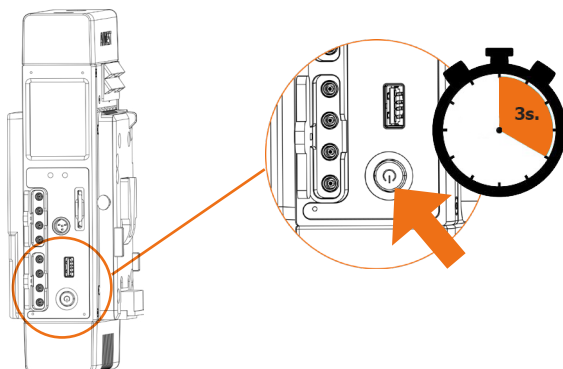

All technical documents

Scan the following QR Code to access the Aviwest portal and get access to all technical documents (user guide, release notes...).

